



Submittal Data Information

FI Series Pumps

301-1427

EFFECTIVE: MARCH 1, 2010

SUPERSEDES: OCTOBER 1, 2009

1160 RPM MODEL 3009

JOB _____ ENGINEER _____

CONTRACTOR _____ REP. _____

ITEM NO.	MODEL NO.	IMPELLER DIA.	G.P.M.	HEAD/FT.	H.P.	ELEC. CHAR.

WEIGHT _____ PUMP/MOTOR _____

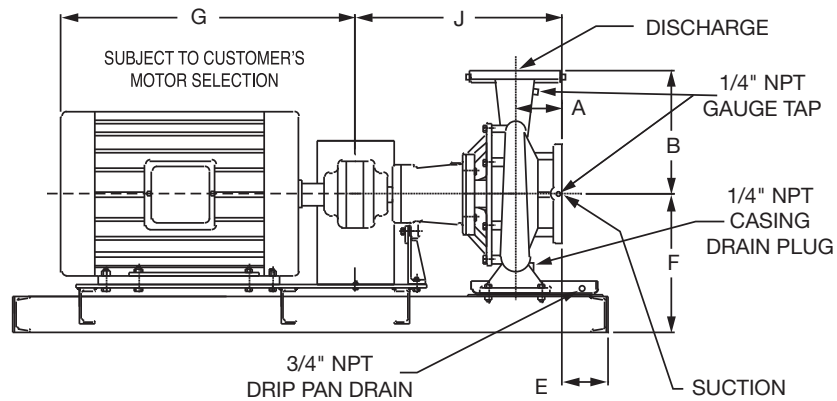
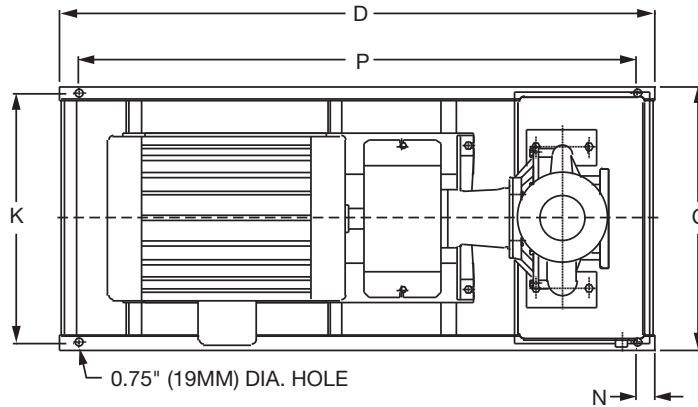

DIMENSIONS

50 Cycle Performance Curves attached when applicable.

Model No. Flange Size (Suction x Discharge)	Motor Frame	HP 1160 (RPM)	A		B		C	D	E		F	G	J		K	N	P
			ANSI Class 125	ANSI Class 250	ANSI Class 125	ANSI Class 250			ANSI Class 125	ANSI Class 250			ANSI Class 125	ANSI Class 250			
3009 4 x 3 (102 x 76)	145T	1	4.73 (120)	5.04 (128)	10.00 (254)	10.37 (263)	16.17 (411)	41.5 (1054)	1.04 (26)	0.73 (19)	11.40 (290)	13.00 (330)	23.24 (590)	23.55 (598)	14.67 (373)	2.00 (51)	37.5 (953)
	182T	1.5					16.17 (411)	41.5 (1054)	1.04 (26)	0.73 (19)		15.38 (391)			14.67 (373)		37.5 (953)
	184T	2					16.17 (411)	41.5 (1054)	1.04 (26)	0.73 (19)		16.56 (421)			14.67 (373)		37.5 (953)
	213T	3					16.17 (411)	41.5 (1054)	1.04 (26)	0.73 (19)		17.94 (456)			14.67 (373)		37.5 (953)
	215T	5					16.17 (411)	41.5 (1054)	1.04 (26)	0.73 (19)		18.19 (462)			14.67 (373)		37.5 (953)

English dimensions are in inches. Metric dimensions are in millimeters. Metric data is presented in ().
Do not use for construction purposes unless certified.

MATERIALS OF CONSTRUCTION

Item	BRONZE FITTED		ALL IRON	
	Std. Pump Constr.	Optional	Standard	Optional
Casing	Cast Iron ASTM A48 Class 30A	N/A	Cast Iron ASTM A48 Class 30A	N/A
Impeller	Bronze ASTM B584-836	N/A	Cast Iron ASTM A48 Class 30A	N/A
Wear Ring	N/A	Bronze ASTM B584-932 SAE660	N/A	N/A
Shaft	Carbon Steel AISI 1045	St. Steel AISI 416 ASTM A582	Carbon Steel AISI 1045	St. Steel AISI 416 ASTM A582
Shaft Sleeve	Bronze ASTM B584-932 SAE660	St. Steel AISI 303 ASTM A276	St. Steel AISI 303 ASTM A276	N/A
Mech. Seal	Ceramic/ EPT	CF	Ceramic/ EPT	CF
Seal Flush Line	N/A	Copper	N/A	Stainless Steel

CF - Consult Factory

N/A - Not Available

OPERATING SPECIFICATIONS

	Standard	Optional
Flange	ANSI Class 125	ANSI Class 250
Pressure	175 PSIG* (1210 KPA)	300 PSIG** (2070 KPA)
Temperature	250°F (120°C)	250°F (120°C)

Motors: All NEMA Standard (T Frame)
 * In accordance with ANSI Standard B16.1 Class 125
 ** In accordance with ANSI Standard B16.1 Class 250 Dim.

MAXIMUM ASSEMBLY WEIGHT

Motor Frame	Weight Lbs (Kg)
143T - 145T	364 (165)
182T - 184T	414 (188)
213T - 215T	498 (226)

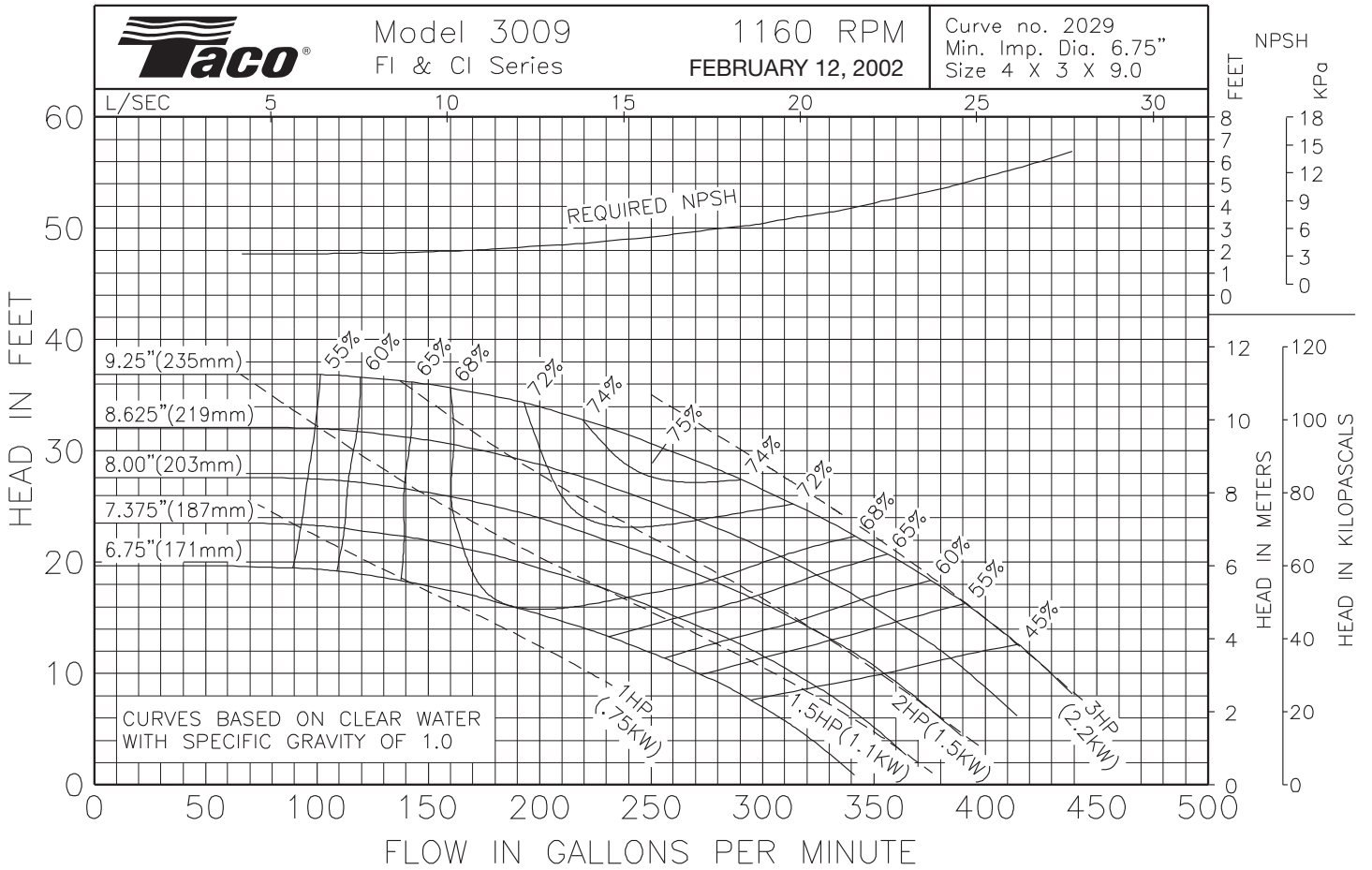



Submittal Data Information

FI Series Pumps

301-1428

EFFECTIVE: NOVEMBER 1, 2010

SUPERSEDES: MARCH 1, 2010

1760 RPM MODEL 3009

JOB _____ ENGINEER _____

CONTRACTOR _____ REP. _____

ITEM NO.	MODEL NO.	IMPELLER DIA.	G.P.M.	HEAD/FT.	H.P.	ELEC. CHAR.

WEIGHT _____ PUMP/MOTOR _____

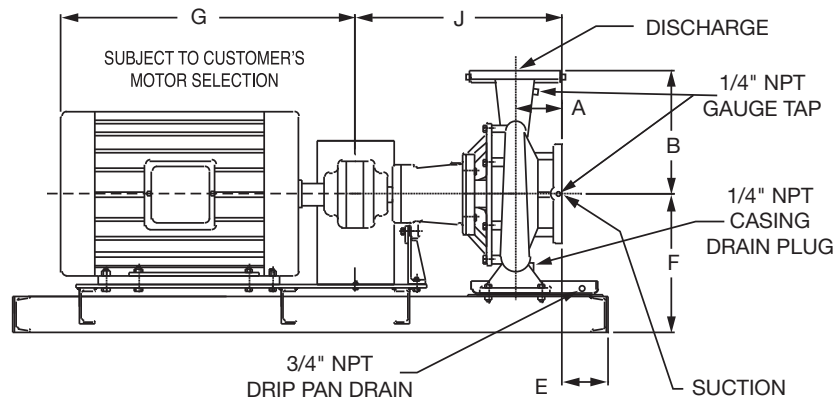
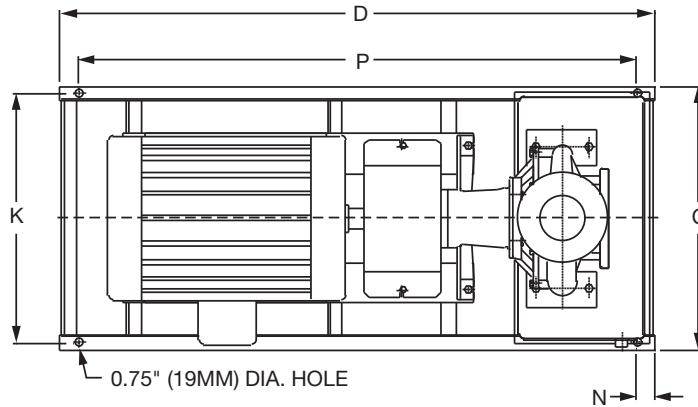

DIMENSIONS

50 Cycle Performance Curves attached when applicable.

Model No. Flange Size (Suction x Discharge)	Motor Frame	HP 1760 (RPM)	A		B		C	D	E		F	G	J		K	N	P
			ANSI Class 125	ANSI Class 250	ANSI Class 125	ANSI Class 250			ANSI Class 125	ANSI Class 250			ANSI Class 125	ANSI Class 250			
3009 4 x 3 (102 x 76)	182T	3	4.73 (120)	5.04 (128)	10.00 (254)	10.37 (263)	16.17 (411)	41.5 (1054)	1.04 (26)	0.73 (19)	11.40 (290)	15.38 (391)	23.24 (590)	23.55 (598)	14.67 (373)	2.00 (50)	37.5 (953)
	184T	5					16.17 (411)	41.5 (1054)	1.04 (26)	0.73 (19)		16.56 (421)			14.67 (373)		37.5 (953)
	213T	7.5					16.17 (411)	41.5 (1054)	1.04 (26)	0.73 (19)		17.94 (456)			14.67 (373)		37.5 (953)
	215T	10					16.17 (411)	41.5 (1054)	1.04 (26)	0.73 (19)		18.19 (462)			14.67 (373)		37.5 (953)
	254T	15					19.17 (487)	49.0 (1245)	1.14 (29)	0.83 (21)		21.69 (551)			17.67 (449)		45.0 (1143)

English dimensions are in inches. Metric dimensions are in millimeters. Metric data is presented in ().
Do not use for construction purposes unless certified.

MATERIALS OF CONSTRUCTION

Item	BRONZE FITTED		ALL IRON	
	Std. Pump Constr.	Optional	Standard	Optional
Casing	Cast Iron ASTM A48 Class 30A	N/A	Cast Iron ASTM A48 Class 30A	N/A
Impeller	Bronze ASTM B584-836	N/A	Cast Iron ASTM A48 Class 30A	N/A
Wear Ring	N/A	Bronze ASTM B584-932 SAE660	N/A	N/A
Shaft	Carbon Steel AISI 1045	St. Steel AISI 416 ASTM A582	Carbon Steel AISI 1045	St. Steel AISI 416 ASTM A582
Shaft Sleeve	Bronze ASTM B584-932 SAE660	St. Steel AISI 303 ASTM A276	St. Steel AISI 303 ASTM A276	N/A
Mech. Seal	Ceramic/ EPT	CF	Ceramic/ EPT	CF
Seal Flush Line	N/A	Copper	N/A	Stainless Steel

CF - Consult Factory

N/A - Not Available

OPERATING SPECIFICATIONS

	Standard	Optional
Flange	ANSI Class 125	ANSI Class 250
Pressure	175 PSIG* (1210 KPA)	300 PSIG** (2070 KPA)
Temperature	250°F (120°C)	250°F (120°C)

Motors: All NEMA Standard (T Frame)
 * In accordance with ANSI Standard B16.1 Class 125
 ** In accordance with ANSI Standard B16.1 Class 250 Dim.

MAXIMUM ASSEMBLY WEIGHT

Motor Frame	Weight Lbs (Kg)
182T - 184T	419 (190)
213T - 215T	509 (231)
254T - 256T	560 (254)

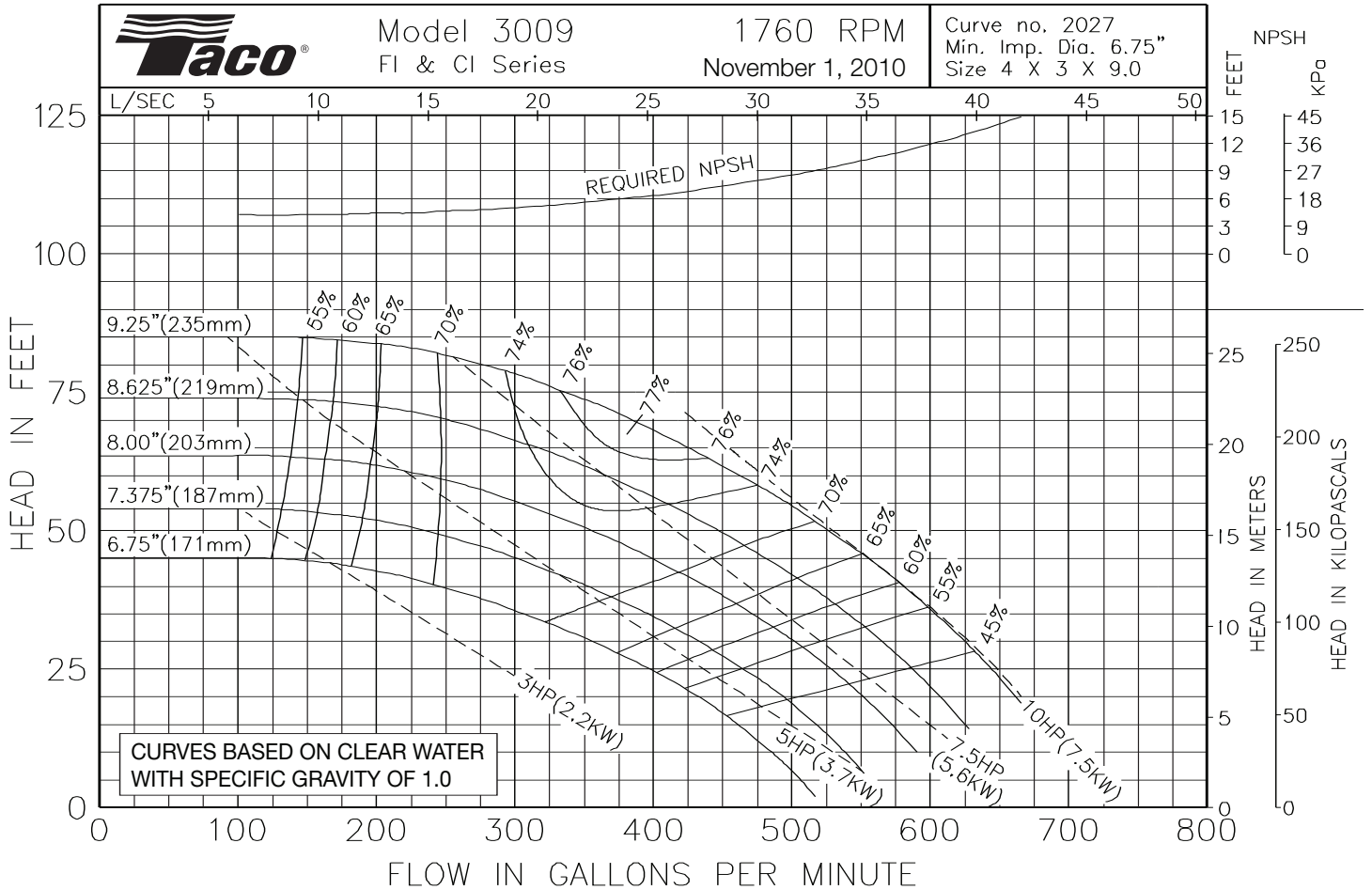



Submittal Data Information

FI Series Pumps

301-1429

EFFECTIVE: NOVEMBER 1, 2010

SUPERSEDES: MARCH 1, 2010

3500 RPM MODEL 3009

JOB _____ ENGINEER _____

CONTRACTOR _____ REP. _____

ITEM NO.	MODEL NO.	IMPELLER DIA.	G.P.M.	HEAD/FT.	H.P.	ELEC. CHAR.
----------	-----------	---------------	--------	----------	------	-------------

WEIGHT _____ PUMP/MOTOR _____

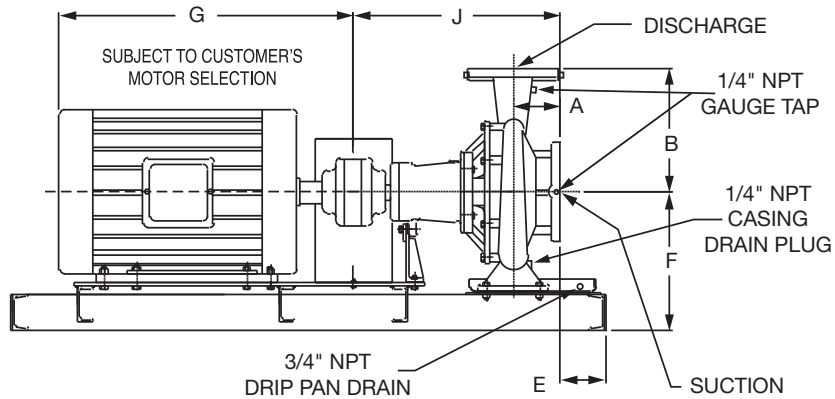
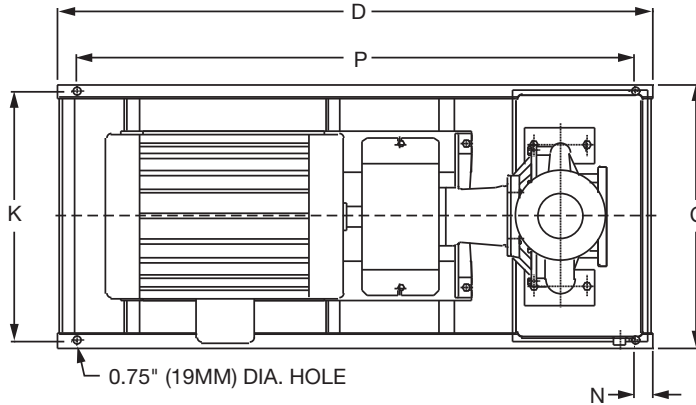

DIMENSIONS

50 Cycle Performance Curves attached when applicable.

Model No. Flange Size (Suction x Discharge)	Motor Frame	HP 3500 (RPM)	A		B		C	D	E		F	G	J		K	N	P
			ANSI Class 125	ANSI Class 250	ANSI Class 125	ANSI Class 250			ANSI Class 125	ANSI Class 250			ANSI Class 125	ANSI Class 250			
3009 4 x 3 (102 x 76)	286TS	30	4.73 (120)	5.04 (128)	10.00 (254)	10.37 (263)	21.17 (538)	56.0 (1422)	2.11 (54)	1.80 (46)	11.40 (290)	25.06 (637)	23.24 (590)	23.55 (598)	19.67 (500)	2.00 (50)	52.0 (1321)
	324TS	40					21.17 (538)	56.0 (1422)	2.11 (54)	1.80 (46)		26.69 (678)			19.67 (500)		52.0 (1321)
	326TS	50					21.17 (538)	56.0 (1422)	2.11 (54)	1.80 (46)		27.69 (703)			19.67 (500)		52.0 (1321)
	364TS	60					21.17 (538)	56.0 (1422)	2.11 (54)	1.80 (46)		29.69 (754)			19.67 (500)		52.0 (1321)
	365TS	75					21.17 (538)	56.0 (1422)	2.11 (54)	1.80 (46)		29.69 (754)			19.67 (500)		52.0 (1321)
	405TS	100					21.17 (538)	56.0 (1422)	2.11 (54)	1.80 (46)		34.00 (864)			19.67 (500)		52.0 (1321)

English dimensions are in inches. Metric dimensions are in millimeters. Metric data is presented in ().
Do not use for construction purposes unless certified.

MATERIALS OF CONSTRUCTION

Item	BRONZE FITTED		ALL IRON	
	Std. Pump Constr.	Optional	Standard	Optional
Casing	Cast Iron ASTM A48 Class 30A	N/A	Cast Iron ASTM A48 Class 30A	N/A
Impeller	Bronze ASTM B584-836	N/A	Cast Iron ASTM A48 Class 30A	N/A
Wear Ring	N/A	Bronze ASTM B584-932 SAE660	N/A	N/A
Shaft	Carbon Steel AISI 1045	St. Steel AISI 416 ASTM A582	Carbon Steel AISI 1045	St. Steel AISI 416 ASTM A582
Shaft Sleeve	Bronze ASTM B584-932 SAE660	St. Steel AISI 303 ASTM A276	St. Steel AISI 303 ASTM A276	N/A
Mech. Seal	Ceramic/EPT	CF	Ceramic/EPT	CF
Seal Flush Line	N/A	Copper	N/A	Stainless Steel

CF - Consult Factory

N/A - Not Available

OPERATING SPECIFICATIONS

	Standard	Optional
Flange	ANSI Class 125	ANSI Class 250
Pressure	175 PSIG* (1210 KPA)	300 PSIG** (2070 KPA)
Temperature	250°F (120°C)	250°F (120°C)

Motors: All NEMA Standard (T Frame)
 * In accordance with ANSI Standard B16.1 Class 125
 ** In accordance with ANSI Standard B16.1 Class 250 Dim.

MAXIMUM ASSEMBLY WEIGHT

Motor Frame	Weight Lbs (Kg)
284T - 286T	687 (312)
324T - 326T	880 (399)
364T - 365T	1087 (493)
404T - 405T	1418 (643)

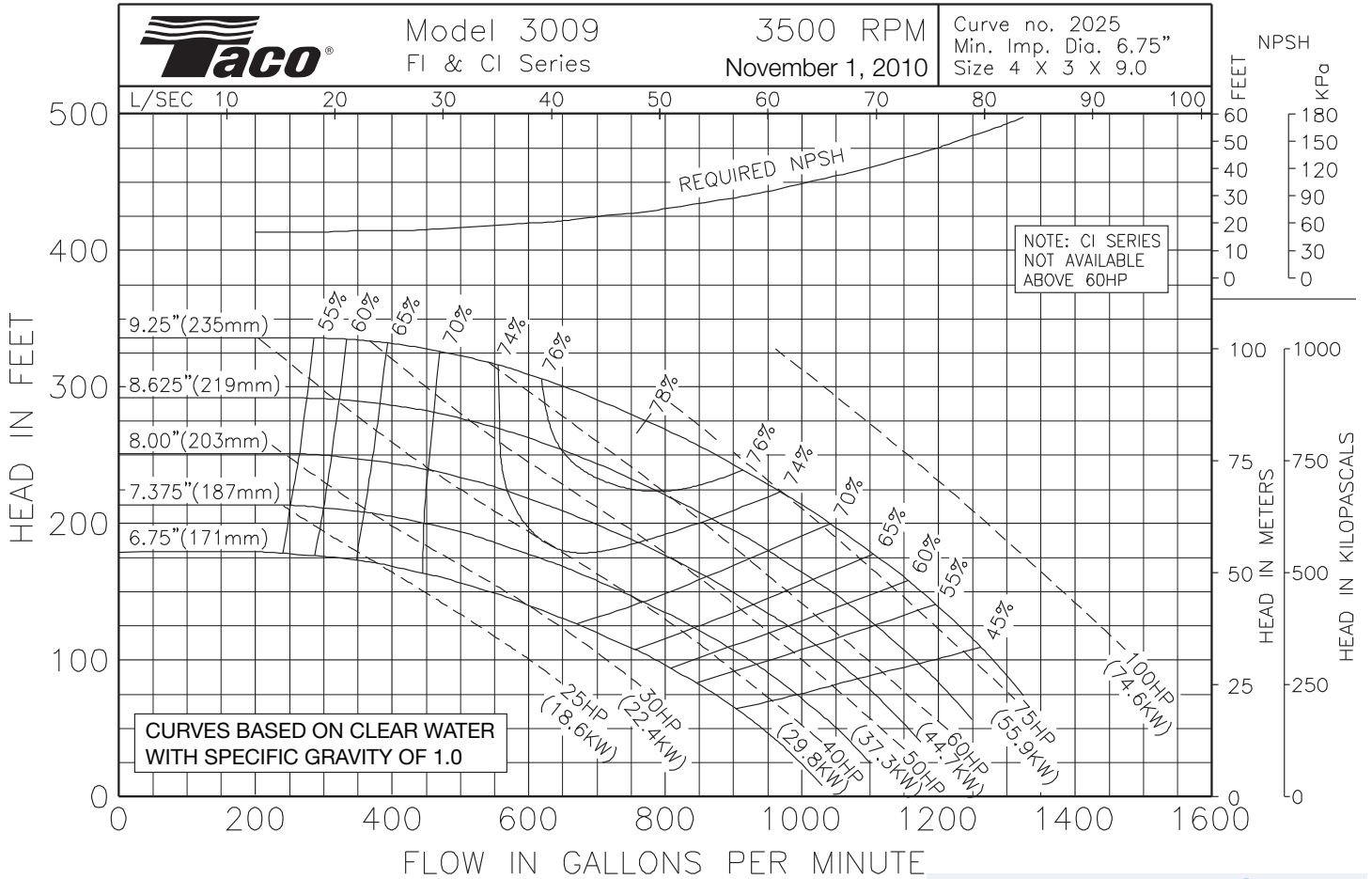

LENNTECH
 WATER TREATMENT Solutions
 info@lennotech.com Tel. +31-152-610-900
 www.lennotech.com Fax. +31-152-616-289